

APPROXIMATE QUANTITIES

1. 12" C&G	1000
2. 12" C&G	1000
3. 12" C&G	1000
4. 12" C&G	1000
5. 12" C&G	1000
6. 12" C&G	1000
7. 12" C&G	1000
8. 12" C&G	1000
9. 12" C&G	1000
10. 12" C&G	1000
11. 12" C&G	1000
12. 12" C&G	1000
13. 12" C&G	1000
14. 12" C&G	1000
15. 12" C&G	1000
16. 12" C&G	1000
17. 12" C&G	1000
18. 12" C&G	1000
19. 12" C&G	1000
20. 12" C&G	1000
21. 12" C&G	1000
22. 12" C&G	1000
23. 12" C&G	1000
24. 12" C&G	1000
25. 12" C&G	1000
26. 12" C&G	1000
27. 12" C&G	1000
28. 12" C&G	1000
29. 12" C&G	1000
30. 12" C&G	1000


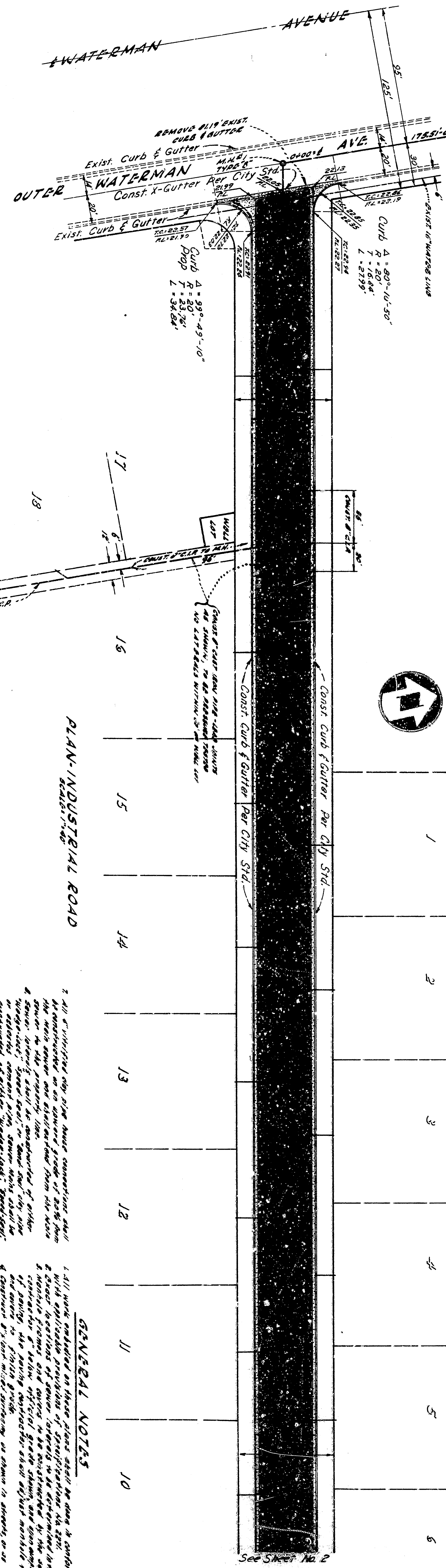

GENERAL NOTES

1. ALL work indicated on these plans shall be done in conformity with applicable provisions of specifications, the 1926 Standard Specifications for Highway Construction, the 1926 Standard Specifications for Sewerage and Sanitation, and the 1926 Standard Specifications for Water Supply.
2. The sewer lines shown on these plans shall be installed in accordance with the 1926 Standard Specifications for Sewerage and Sanitation.
3. The manholes shown on these plans shall be installed in accordance with the 1926 Standard Specifications for Sewerage and Sanitation.
4. The curbs and gutters shown on these plans shall be installed in accordance with the 1926 Standard Specifications for Highway Construction.
5. The street widening shown on these plans shall be done in accordance with the 1926 Standard Specifications for Highway Construction.
6. The utility lines shown on these plans shall be installed in accordance with the 1926 Standard Specifications for Utility Lines.
7. The existing utility lines shown on these plans shall be protected in accordance with the 1926 Standard Specifications for Utility Lines.
8. The existing structures shown on these plans shall be protected in accordance with the 1926 Standard Specifications for Structures.
9. The existing easements shown on these plans shall be protected in accordance with the 1926 Standard Specifications for Easements.
10. The existing rights-of-way shown on these plans shall be protected in accordance with the 1926 Standard Specifications for Rights-of-Way.
11. The existing survey monuments shown on these plans shall be protected in accordance with the 1926 Standard Specifications for Survey Monuments.
12. The existing utility poles shown on these plans shall be protected in accordance with the 1926 Standard Specifications for Utility Poles.
13. The existing street lighting shown on these plans shall be protected in accordance with the 1926 Standard Specifications for Street Lighting.
14. The existing street furniture shown on these plans shall be protected in accordance with the 1926 Standard Specifications for Street Furniture.
15. The existing street signs shown on these plans shall be protected in accordance with the 1926 Standard Specifications for Street Signs.
16. The existing street trees shown on these plans shall be protected in accordance with the 1926 Standard Specifications for Street Trees.
17. The existing street benches shown on these plans shall be protected in accordance with the 1926 Standard Specifications for Street Benches.
18. The existing street lamps shown on these plans shall be protected in accordance with the 1926 Standard Specifications for Street Lamps.
19. The existing street hydrants shown on these plans shall be protected in accordance with the 1926 Standard Specifications for Street Hydrants.
20. The existing street valves shown on these plans shall be protected in accordance with the 1926 Standard Specifications for Street Valves.
21. The existing street fire hydrants shown on these plans shall be protected in accordance with the 1926 Standard Specifications for Street Fire Hydrants.
22. The existing street fire valves shown on these plans shall be protected in accordance with the 1926 Standard Specifications for Street Fire Valves.
23. The existing street fire hydrant valves shown on these plans shall be protected in accordance with the 1926 Standard Specifications for Street Fire Hydrant Valves.
24. The existing street fire hydrant valves shown on these plans shall be protected in accordance with the 1926 Standard Specifications for Street Fire Hydrant Valves.
25. The existing street fire hydrant valves shown on these plans shall be protected in accordance with the 1926 Standard Specifications for Street Fire Hydrant Valves.

② Revision: Curb and gutter, paving, & sewer extended from 6 Sta 12+84.72 to 6 Sta 12+41.66 Industrial Road. See sheet 115-241.

NESTE & BRUDIN
CIVIL ENGINEERS
151 West Fifth St., San Bernardino, Calif.

TRACT 6548
INDUSTRIAL ROAD
IMPROVEMENT PLANS
SHEET 62
2973

